

# Bestway®

## 58678



©2022 Bestway Inflatables & Material Corp.

All rights reserved/Tous droits réservés/Todos los derechos reservados/Alle Rechte vorbehalten/Tutti i diritti riservati

Trademarks used in some countries under license from/

Marques utilisées dans certains pays sous la licence de/

Marcas comerciales utilizadas en algunos países bajo la licencia de/

Die Warenzeichen werden in einigen Ländern verwendet unter Lizenz der/

Marchi utilizzati in alcuni paesi concessi in licenza a

**Bestway Inflatables & Material Corp., Shanghai, China**

Manufactured, distributed and represented in the European Union by/

Fabriqué, distribué et représenté dans l'Union Européenne par/Fabricado, distribuido y representado en la Unión Europea por/

Hergestellt, vertrieben und in der Europäischen Union vertreten von/Prodotto, distribuito e rappresentato nell'Unione Europea da

**Bestway Europe S.p.a., Via Resistenza, 5, 20098 San Giuliano Milanese (Milano), Italy**

Distributed in Latin America by/Distribué en Amérique latine par/Distribuido en Latinoamérica por/Distribuido en América Latina por

**Bestway Central & South America Ltda, Salar Ascotan 1282, Parque Enea, Pudahuel, Santiago, Chile**

Distributed in Australia & New Zealand by **Bestway Australia Pty Ltd, Unit 2/98-104 Camarvon St Silverwater, NSW 2128, Australia**

Tel: Australia: (+61) 2 9037 1388; New Zealand: 0800 142 101

Distributed in United Kingdom by **Bestway Corp UK Ltd, 8 Wentworth Road, Heathfield Industrial Estate, Newton Abbot, Devon, TQ12 6TL**

Exported by/Exporté par/Exportado por/Exportiert von/Esportato da

**Bestway (Hong Kong) International Ltd./Bestway Enterprise Company Limited**

Suite 713, 7/Floor, East Wing, Tsim Sha Tsui Centre, 66 Mody Road, Kowloon, Hong Kong

[www.bestwaycorp.com](http://www.bestwaycorp.com)



# OWNER'S MANUAL

## 58678 Chlorinator



Visit the Bestway YouTube channel

### IMPORTANT SAFETY INSTRUCTIONS

#### READ AND FOLLOW ALL INSTRUCTIONS.

Carefully read, understand, and follow all information in this user manual before installing and using the Chlorinator. These warnings, instructions, and safety guidelines address some common risks, but they cannot cover all risks and dangers in all cases. Always use caution, common sense and good judgment when using the Chlorinator. Retain this information for future use. In addition, the following information can vary depending on the Chlorinator type. Keep the instruction manual in a safe place. If instructions are missing, please contact the manufacturer or search it on the website [www.bestwaycorp.com](http://www.bestwaycorp.com).

#### WARNING

- If the supply cord is damaged, it must be replaced by the manufacturer, its service agent or similarly qualified persons in order to avoid a hazard.
- This appliance can be used by children aged from 8 years and above and persons with reduced physical, sensory or mental capabilities or lack of experience and knowledge if they have been given supervision or instruction concerning use of the appliance in a safe way and understand the hazards involved. Children shall not play with the appliance. Cleaning and user maintenance shall not be made by children without supervision.
- If instructions are missing, please contact the manufacturer or search it on the website [www.bestwaycorp.com](http://www.bestwaycorp.com).



DISPOSAL

Electrical products should not be disposed of with household waste. Please recycle where facilities exist. Check with your local authority or retailer for recycling advice.

# SETUP

## CHECK LIST

To check the parts inside the manual. Verify that the equipment components represent the model that you had intended to purchase. In case of any damaged or missing parts at the time of purchase, visit our website [bestwaycorp.com/support](http://bestwaycorp.com/support). Drawings are for illustration purposes only. May not reflect actual product. Not to scale.

## PRODUCT SPECIFICATIONS

Maximum chlorine production per hour:	6 g/h
Sand filter/Filter pump flow range:	330-3000 gal/h
Salt concentration:	3000 ppm (3 g/L)
Water temperature:	10-36°C
Ambient temperature:	5-45°C
Compatible with max water capacity:	7000 gal (26495 L)

## RECOMMENDATIONS BEFORE INSTALLATION

- The chlorinator must be installed at the last position of the water circulation pipe (down the direction of the water flow) as shown in "1a. and 1b."
- Only use sodium chloride (NaCl) salt with a purity of at least 99.8% to fully dissolve it.
- Too low salt content will reduce the efficiency of the chlorinator and result in low chlorine production. High salt content may produce a salty taste to the pool water and it may cause corrosion to metal fixtures and fittings in the pool.
- The "Pool Salt Table" shows the correct amount of salt required. Refer to the different quantity of water. The salt in the pool will not automatically decrease.
- Only when the pool water is lost will the salt in the water decrease, and the evaporation of water will not cause the salt to decrease.







Pool Salt Table					
Pool capacity		The amount of salt added for the first time 3.0 g/L (3000 ppm)		Display code "E1" the amount of salt that needs to be added	
(gal)	(l)	(lb)	(kg)	(lb)	(kg)
1000	3785	25	11	8	4
1500	5677	38	17	13	6
2000	7570	50	23	17	8
3000	11355	75	34	25	11
4000	15140	100	45	33	15
5000	18925	125	57	42	19
6000	22710	150	68	50	23
7000	26495	175	79	58	26

If the device shows error E2, it is necessary to reduce the salt concentration: Drain about 20% of the pool water, and then refill with clean water. Wait 1 hour, and if the error still remains, repeat the operation until the E2 error disappears.

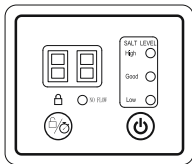
In case the quantity of water of your pool is not listed in the "pool salt table", follow the below formula to calculate the correct quantity of salt to add to the pool to reach the 3000 ppm of salt concentration, or in case the E1 error appears on the display.

The amount of salt added for the first time:		The amount of salt that needs to be added if the "E1" error code displays:	
(lb)	(kg)	(lb)	(kg)
Water capacity(gal) *0.025	Water capacity(l) *0.003	Water capacity(gal) *0.0084	Water capacity(l) *0.001

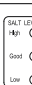
## USING THE CHLORINATOR

	Code number	Icon	Name	Illustrate
	1		Power button	Press and hold for 3s to turn on/off the chlorinator
	2		Timer button	Press and hold for 3s to lock/unlock, and press quickly to adjust working time
	3		Lock indicator	When the lock indicator is unlit, the product is unlocked. If no button is pressed, the product will automatically lock after 1 minute and the Lock indicator will turn red.
	4		Salt concentration indicator	Red: The salt concentration is too high, part of the salt should be removed from the pool water. Display shows: E2; Green: The salt concentration is at the optimal level; Yellow: The salt concentration is too low and salt needs to be added to the pool water. Display shows: E1.
	5		Water flow status indicator	Shows red, no water flow or insufficient water flow
	6		Digital Display	Displays running time/remaining time/fault code Power-on state/standby mode

Standby mode: At the end of the cycle, the display shows "00". At this time, the chlorinator will automatically enter the standby mode. The day after, approximately at the same time, it will automatically run again. If you unplug the Chlorinator, connect the plug the next day, and press the power button, the chlorinator will work according to the working hours set the previous day.

**Recommended Pool Working Time Set Table**

1. This table shows the recommended working hours for the normal maintenance of the chlorinator connected to the pool.
2. For cleaning the pool, please run it at 1.5-2 times the time shown in the table for the first use, and run it according to the normal working hours once the chlorine level is reached.
3. On the first use or if the water in the pool is dirty, run the chlorinator until the level of chlorine is correct or the water is clean. Refer to the working time shown in the table below.

Pool size		Working time (hours) under different ambient temperatures		
Gallon	Litre	10 - 19°C(50 - 66°F)	20 - 28°C(68 - 82°F)	29 - 36°C(84 - 97°F)
1000	3785	1	1	1
2000	7570	2	3	3
3000	11355	4	4	5
4000	15140	5	6	7
5000	18925	6	7	8
6000	22710	7	8	9
7000	26495	8	9	10

It is recommended to cover the surface of the pool during the operation of the product to help increase the level of chlorine in the pool.

#### ATTACHING A BASE TO THE CHLORINATOR

Follow the below instructions. There must be two holes with a diameter of 8 mm and a spacing of 165 mm on the base. The product can be fixed on a cement base or a wooden platform. The total weight of the base should not be less than 18 kg to protect the chlorinator from accidentally falling over.

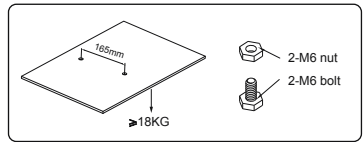
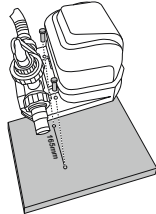

## MAINTENANCE

#### ELECTROLYTIC CELL

To clean the electrolytic cell, follow the instruction in the section . Drawings are for illustration purposes only. May not reflect actual product. Not to scale. In order to maintain the best results, we recommend opening and checking the electrodes every month. However, if the water quality of the swimming pool is hard water (high content of calcium and magnesium ions), the electrodes may need to be cleaned manually on a regular basis. To clean the electrolytic cell, it is suggested to use a solution of 50% water/50% vinegar, or check with your pool dealer the suitable chemical product. Be sure to avoid chemical product that can damage the Titanium plate.

#### WATER CHEMICAL BALANCE

	Minimum	Best Value	Maximum
Available chlorine	0	0.5 - 3.0 ppm	3.0 ppm
Combined chlorine	0	0	0.2 ppm
pH value	7.2	7.4 - 7.6	7.8
Total alkalinity	40 ppm	80 - 100 ppm	120 ppm
The hardness of calcium	50 ppm	100- 250 ppm	350 ppm
Stabilizer (cyanuric acid)	10 ppm	20 - 40 ppm	50 ppm

\* If the concentration of chlorine exceed the recommended level, it can be dangerous to use the pool. Test the chemical balance before using the pool. If using the test strip, check the expiration date, as the test result may be inaccurate if passed the expiration date.

#### BESTWAY® TEST STRIPS (INCLUDED IN THE PRODUCT)

The test strips can test the concentration of "free chlorine", "PH" and "total alkalinity" in the water at the same time. It is recommended to check the level of the chemical in the water every day and before use.

- Immerse a whole strip of test paper in water and take it out immediately.
- Keep the test paper level and wait for 15 seconds. Do not shake off excess water.
- Please compare the "free chlorine", "PH" and "total alkalinity" grades of the test paper with the color plate attached to the bottle.

## STORAGE

- Remove all accessories; be sure to clean and dry all before the storage. If all the parts are not completely dry, mold may result. We strongly recommend to disassemble the Chlorinator when the environment temperature is below 10°C / 50°F.
- Store the Chlorinator in a dry place with a moderate temperature between 10°C / 50°F and 38°C / 100°F.

# WARRANTY TERMS

For information concerning warranty terms, visit our website at: [www.bestwaycorp.com](http://www.bestwaycorp.com).

# TROUBLESHOOTING

Problems	Probable Causes	Solutions
Insufficient chlorine concentration	<ul style="list-style-type: none"> <li>The running time of the product is not long enough.</li> <li>The salt concentration is not enough (less than 2000 ppm).</li> <li>The electrolyzer is blocked or left with dirt.</li> <li>Increase in swimmers.</li> <li>Strong exposure to the sun leads to the emission of chlorine.</li> </ul>	<ul style="list-style-type: none"> <li>Please increase the running time of the product every day. For details, please refer to "Operation Instructions".</li> <li>Adjust the salt concentration by referring to the "Pool Salt Table".</li> <li>If necessary, please disassemble the electrolytic cell for inspection and cleaning. Please refer to "Maintenance".</li> <li>Please increase the running time of the product every day. When the pool is not in use or the product is running, please cover the pool cover.</li> <li>Please increase the running time of the product every day. During the running of the product, you can cover the surface of the pool and wait 2 days before using the test paper to test.</li> </ul>
Flocculent precipitation in water	There is too much calcium in the pool water.	Empty about 20%-25% of the pool water volume, then add clean water to reduce the hardness. If necessary, please disassemble the electrolytic cell for inspection and cleaning.
LED indicator has no display code	<ul style="list-style-type: none"> <li>Not plugged in.</li> <li>The GFCI plug is not set.</li> <li>The LED indicator fails.</li> </ul>	<ul style="list-style-type: none"> <li>Plug in the power plug.</li> <li>Press the reset button again.</li> <li>Please contact Bestway Customer Service Center for replacement.</li> </ul>

# ERROR CODES

Problems	Probable Causes	Solutions
Display code "E0"	No water flow.	Make sure the filter is connected to the chlorinator and is running. See "Installation Instructions".
	The water flow is less than 280 gal/h (1050 L/h), the circulation system is blocked.	If there is a water stop valve, make sure that the water stop valve is open. Ensure that the filter element and the electrolytic cell are clean and free of dirt or impurities. Exhaust the air from the entire circulation system. Please refer to the filter manual.
	The direction of the inlet and outlet is reversed.	Check the direction of the water inlet and outlet. If necessary, readjust the water pipe. See "Installation Instructions".
	Dirt in the water flow sensor.	Make sure the water flow sensor is clean (especially the rotor). Please refer to "Maintenance".
	The power cord of the water flow sensor is loose.	Reconnect the water flow sensor firmly.
Display code "E1"	Water flow sensor failure.	Please contact Bestway Customer Service Center for replacement.
	Dirt remains in the electrolyzer.	If necessary, remove the electrode to check and clean it. Please refer to "Maintenance".
	Low salt concentration or no salt.	Add salt. Please refer to "Pool Salt Table".
	The electrolysis power cord is loose.	Make sure that the electrolytic cell line is firmly connected to the plug of the electrolytic cell.
Display code "E2"	The electrolyzer may fail.	Please contact Bestway Customer Service Center for replacement.
	Salt concentration is too high.	Drain part of the pool water and add some clean water. Refer to "Salt and Pool Water Consumption".
Display code "E3"	Electrolyzer short circuit.	If necessary, remove the electrode to check and clean it. Please refer to "Maintenance".

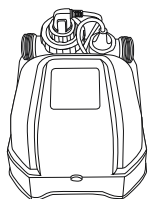

①

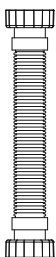

②

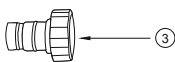

③



④



⑤

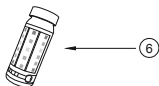

⑥



1a

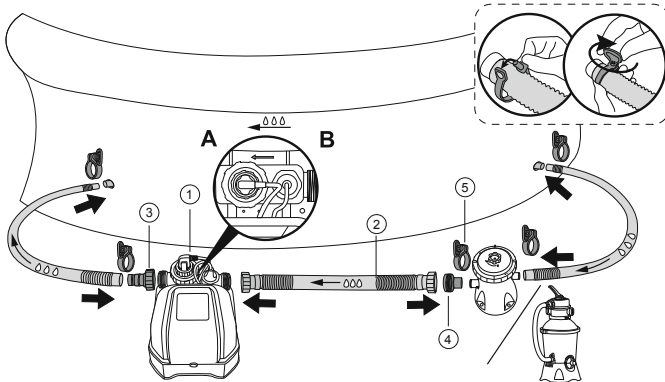

1b

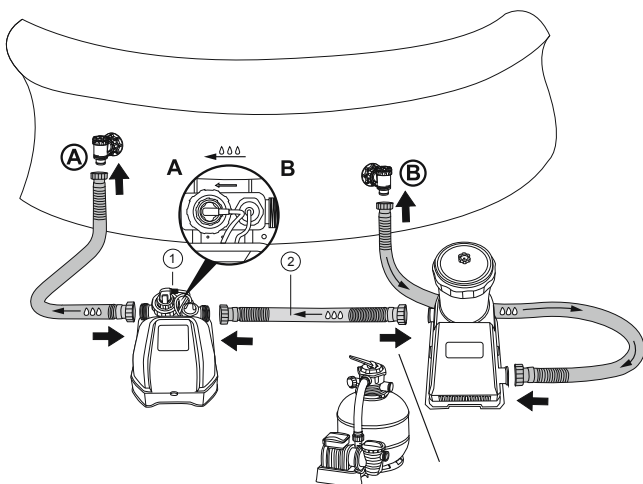

2

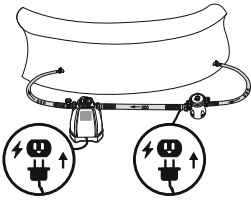

3

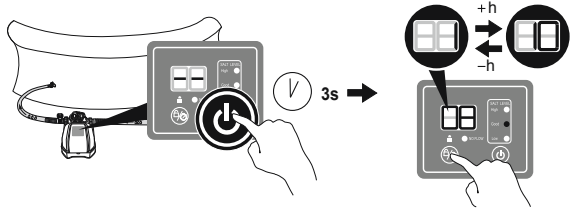

1

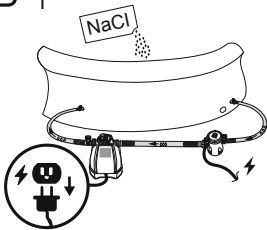

2



3

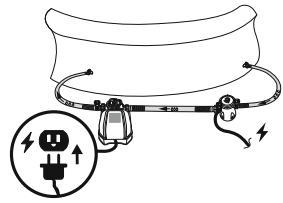

1

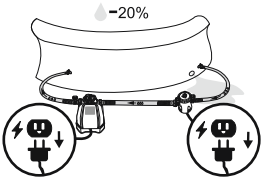

2

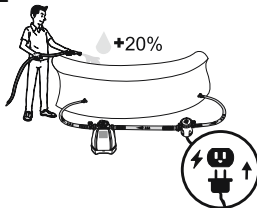

3



4

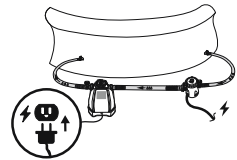

1.1

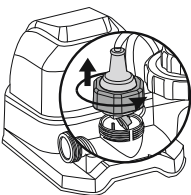

1.2

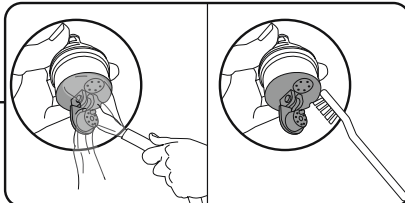

1.3

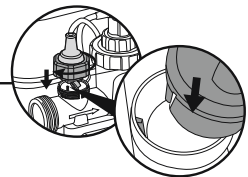

2.1

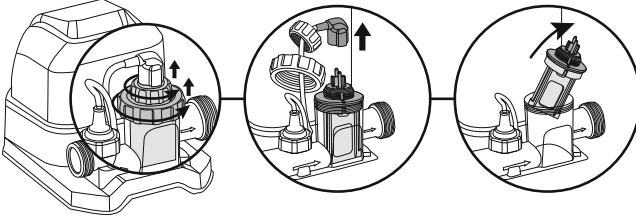

2.2

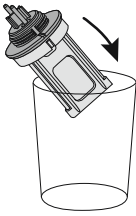

2.3

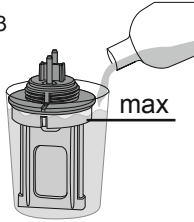

2.4



2.5

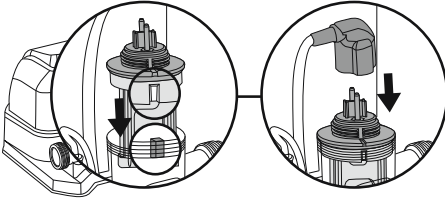

2.6

