



# 58665

©2023 Bestway Inflatables & Material Corp.

All rights reserved/Tous droits réservés/Todos los derechos reservados/Alle Rechte vorbehalten/Tutti i diritti riservati

Trademarks used in some countries under license from/

Marques utilisées dans certains pays sous la licence de/

Marcas comerciales utilizadas en algunos países bajo la licencia de/

Die Warenzeichen werden in einigen Ländern verwendet unter Lizenz der/

Marchi utilizzati in alcuni paesi concessi in licenza a

**Bestway Inflatables & Material Corp., Shanghai, China**

Manufactured, distributed and represented in the European Union by/

Fabriqués, distribués et représentés dans l'Union Européenne par/Fabricado, distribuido y representado en la Unión Europea por/

Hergestellt, vertrieben und in der Europäischen Union vertreten von/Prodotto, distribuito e rappresentato nell'Unione Europea da

**Bestway Europe S.p.a., Via Resistenza, 5, 20098 San Giuliano Milanese (Milano), Italy**

Distributed in Latin America by/Distribué en Amérique latine par/Distribuido en Latinoamérica por/Distribuido na América Latina por

**Bestway Central & South America Ltda, Salar Ascotan 1282, Parque Enea, Pudahuel, Santiago, Chile**

Distributed in Australia & New Zealand by **Bestway Australia Pty Ltd, Unit 2/98-104 Camarvon St Silverwater, NSW 2128, Australia**

Tel: Australia: (+61) 2 9037 1388; New Zealand: 0800 142 101

Distributed in United Kingdom by **Bestway Corp UK Ltd, 8 Wentworth Road, Heathfield Industrial Estate, Newton Abbot, Devon, TQ12 6TL**

Exported by/Exporté par/Exportado por/Exportiert von/Esportato da

**Bestway (Hong Kong) International Ltd./Bestway Enterprise Company Limited**

Suite 713, 7/Floor, East Wing, Tsim Sha Tsui Centre, 66 Mody Road, Kowloon, Hong Kong

[www.bestwaycorp.com](http://www.bestwaycorp.com)

# OWNER'S MANUAL

## TECHNICAL SAFETY INSTRUCTIONS

Save These Instructions – Read carefully before operating.

Follow all safety and operating instructions. This will help to optimize the performance of the robot

- To reduce the risk of injury, do not allow children to use, assemble or disassemble this product. Adults only.
- Do not remove or obstruct the float opening while the filter pump/sand filter is operating.
- Do not use the filter pump/sand filter while the pool is occupied.
- Ensure the filter pump/sand filter is unplugged before any maintenance begins to avoid risk of injury or death.

## SETUP





### PARTS & TOOLS NEEDED

Compare the parts in your box to the parts listed in this manual. Verify that the equipment components represent the model that you had intended to purchase. If any parts are damaged or missing at the time of purchase, please turn to the shop for help.

- Compatible with round above ground pools up to 6.70 m (22 ft.) in diameter and oval or rectangular above ground pools up to 6.70 m (22 ft.) in length.
- Not compatible with: In-ground pools, Round Hydrium pools, Oval Hydrium pools.
- Compatible with: Filter Pumps and Sand Filters with flow rates from 1,500-3,200 gal./h (5,678-12,113 L/h)

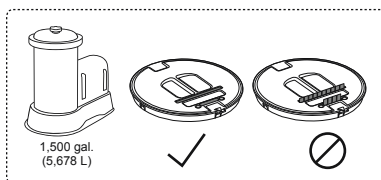
**Important:** Remove the brushes from the cover of the debris screen if you are using a 1,500 gal. (5,678 L) filter pump. This will optimize the performance of the robot. Keep the brushes in place if you are using a higher filtration system within the listed compatibility.



For the setup instructions, you can refer to the steps in the section .

**NOTE:** Drawings are for illustration purposes only. May not reflect actual product. Not to scale.

### Pressure Release Valve

- The robot can be used with filtration pumps with different flow rates. To optimize the performance of the robot, the pressure release valve must be set to the correct position. Below, you will see the different valve positions in reference to different pump flow rates.

**IMPORTANT:** If the setting of the pressure release valve is not correct, the speed of the robot could be too high or too low, and it will reduce the performance of the robot.

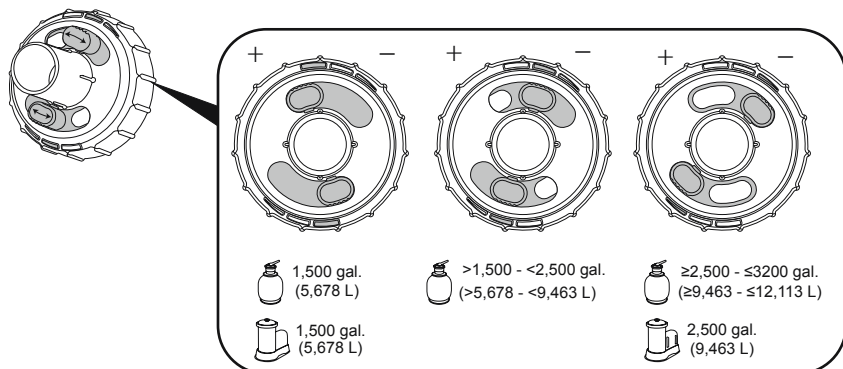

- The robot works using a Venturi technology. The hose must be connected to the inlet of the pool from the filtration system. If the robot is connected to wrong port, it will not work.
- Check the condition of the filter cartridge or the sand before operating the robot. This will increase the flow rate and the performance of the robot.
- On the bottom of the robot near the wheels, there is a switch to determine the angle of the wheels. In Step 2 below, the set of wheel angles is a reference for using the product with different shapes of above ground pools. It can be changed if there is area not reached by the product.
- After setup is complete, activate the robot by turning on the filtration system.

## MAINTENANCE



**IMPORTANT:** Before cleaning the product, unplug the filtration system. The debris compartment and the debris screen inside the pressure release valve must be checked every time before using the product. It will compromise the performance if they are dirty. For the cleaning instructions, you can refer to the steps in the section .

- It's suggested to clean the debris compartment and the debris screen inside the pressure release valve every 1 or 2 hours to increase the performance of the robot.

## STORAGE

- Before storing the robot, make sure there is no remaining water inside of it. The residual water could create mildew and compromise the functionality.
- We strongly recommend disassembling the product during the off-season (winter months) and storing it in a dry place with a moderate temperature between 10°C / 50°F and 38°C / 100°F.

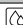
## TROUBLESHOOTING

Problem	Possible Cause	Solution
The robot does not capture the debris, or it moves slowly or does not move at all.	Debris compartment is full.	Clean the debris compartment as shown in Section  .
	Pressure relief valve filter is clogged.	Clean the pressure relief valve filter. Rinse with water to remove debris.
	Pool suction fitting is clogged.	Clean the debris compartment as shown in Section  .
	The filter cartridge or the sand is too dirty.	Filter pump - Clean the filter cartridge or replace if necessary. Sand filter pump - Disconnect the cleaner from the pool, perform backwash and rinse to clean the sand.
	Air inside the pump.	Stop the filter pump or sand filter, purge the air and start again.
	The robot is stuck on wrinkles.	The pool is not set up according to the pool instructions. Drain the water and smooth the bottom of the pool to eliminate the wrinkles and fill the pool again.
	Other pool accessories, such as a chlorinator and/or pool heater is installed.	Remove the additional accessories, as they will reduce the flow rate and the performance of the product during operation.
	The filtration system is too small.	Change the filtration system with the one that meets the size compatibility of the product.
	Wheel is jammed.	Check and remove debris from the wheel.
	The water valve did not open.	Open the water valve.
The hoses are entangled	Damaged debris compartment or pressure relief valve filter.	Return to the shop to get assistance.
	Hose not straightened out.	Turn off the pump and reconnect the product at the diagonal position of the pool (the water hose should be in a C shape). The product should be placed into the water in the direction of the water hose.
	The hose sinks into the water.	Adjust the position of the float to make the hose float on the water.
The driving path of the robot cannot cover the entire pool	The robot running speed is too fast.	Regulate the pressure relief valve.
	The wheels are not in the correct position.	Adjust the wheel driving angle.

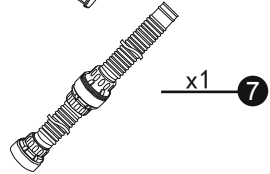
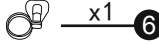
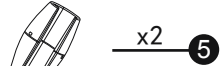
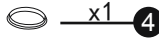
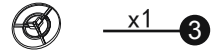
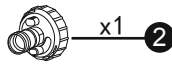
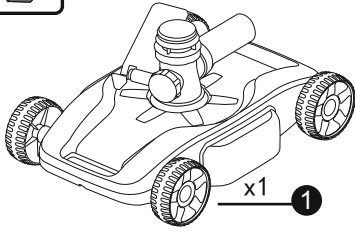

1

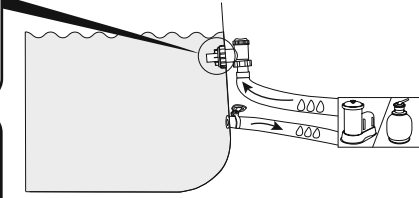
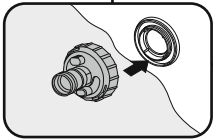
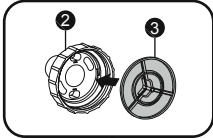
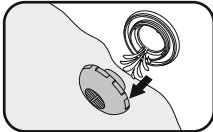

2

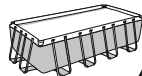
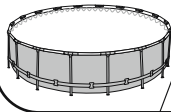
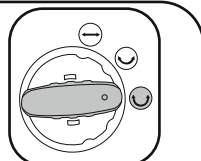
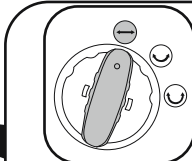
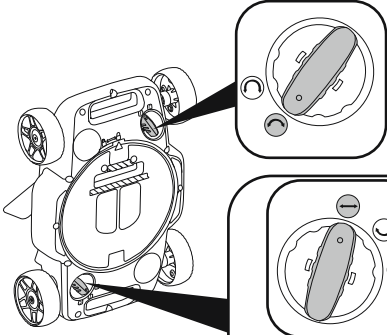

3

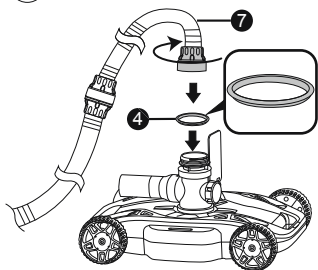

4

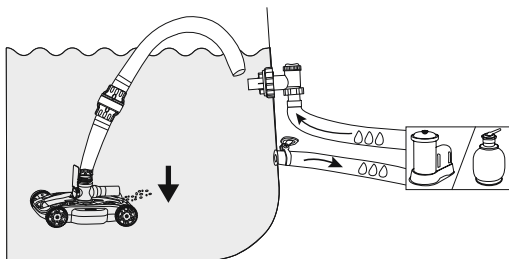

5

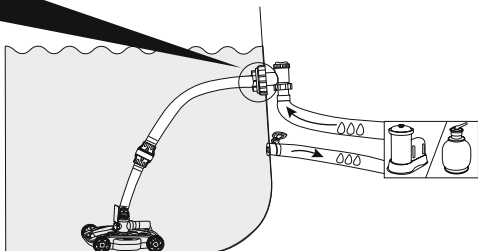
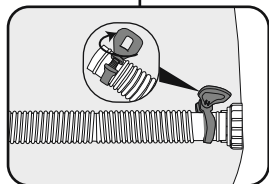
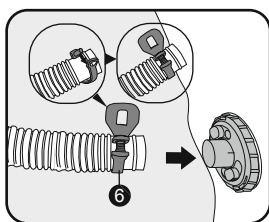

6

