



# Net 'N' Clean Infloor Cleaning System

## INSTALLATION AND OPERATING INSTRUCTIONS





# INDEX

---

## **Introduction**

|                            |   |
|----------------------------|---|
| Introduction .....         | 3 |
| Notice to Installers ..... | 3 |
| Safety Rules .....         | 3 |

## **Operation**

|                                       |   |
|---------------------------------------|---|
| Lighting Instructions .....           | 4 |
| Operating Instructions .....          | 4 |
| Turning Gas Off .....                 | 4 |
| Chemical Balance .....                | 4 |
| Corrosion Prevention in Heaters ..... | 5 |
| Digital Thermostat Operation .....    | 6 |
| Fault Indication .....                | 7 |

## **Maintenance**

|                                |   |
|--------------------------------|---|
| Maintenance Instructions ..... | 8 |
| Energy saving Tips .....       | 8 |
| Winter Operation .....         | 8 |

## **Installation**

|                                  |    |
|----------------------------------|----|
| Installation Instructions .....  | 9  |
| Flow Rates .....                 | 9  |
| Water Connections .....          | 9  |
| Plumbing Diagram .....           | 9  |
| Heater Dimensions .....          | 10 |
| Indoor Installation .....        | 10 |
| Ventilation .....                | 10 |
| .....                            | 11 |
| Clearances .....                 | 11 |
| Electrical Connection .....      | 12 |
| Gas Connection .....             | 12 |
| Pressure Switch Adjustment ..... | 12 |
| .....                            | 13 |
| Starting the Heater .....        | 13 |
| Testing Burner Pressure .....    | 13 |

## **Gas Conversion**

|                         |    |
|-------------------------|----|
| Burner Conversion ..... | 14 |
|-------------------------|----|

## **Troubleshooting**

|                                  |    |
|----------------------------------|----|
| Fault Finding and Remedies ..... | 15 |
|----------------------------------|----|

## **Wiring diagram**

|                                |    |
|--------------------------------|----|
| HX Series Wiring Diagram ..... | 16 |
|--------------------------------|----|

## **Warranty**

|                            |    |
|----------------------------|----|
| Terms and Conditions ..... | 17 |
|----------------------------|----|



For full warranty terms and conditions and to register your warranty, simply visit **[www.astralpool.com.au/warranty](http://www.astralpool.com.au/warranty)** and complete your details. Or scan the QR code and be taken directly to the registration page.

Record your equipment details here for quick reference:

Model No.: \_\_\_\_\_

Serial No.: \_\_\_\_\_

## INTRODUCTION

---

Congratulations on your purchase of an Astral Pool Net 'N' Clean infloor cleaning system. Proper installation and service of your new cleaning system and correct chemical maintenance of the water will ensure years of enjoyment.

The Net 'N' Clean infloor system is a form of suspension cleaning. The system operates by pushing the larger, heavier debris into a central collection point in the pool commonly known as a main drain. For lighter debris and dirt, the water jets created through the infloor nozzles stir this up into suspension and allows the normal filtration system of the pool to collect this debris through its skimmer.

**Note:**

The appliance is not intended for use by young children or infirm person without supervision. Please ensure that young children are supervised to ensure that they do not play with the appliance.

## NOTICE TO INSTALLERS

---

This system must be installed according to all installation guidelines provided in this booklet and in accordance with the design supplied by Astral Pool.

Any deviation or changes to the supplied design can affect the product warranty..

## COMPONENTS INCLUDED

---

- 1 x Distributor Valve
- 1 x Pressure Gauge T with joint
- 1 x 3 bar-psi pressure gauge
- 1 x Roll of Teflon tape
- 1 x Installation and Operation Manual

## GENERAL SPECIFICATIONS

---

The Net N Clean distributor valve is designed to distribute the flow of water through branches of nozzles which are located on the floor of the pool. These nozzles project clean water in the pool to move the debris which has settled.

Distribution to the branches is achieved through a turbine and series of gears which are anchored to the base plate inside the distributor valve. These gears sequentially open and close caps inside the distributor valve to control the flow of water through the branches.

The main advantages of this style of cleaning system include more even distribution of chemicals and temperature throughout the pool and the reduced need for manual intervention in cleaning your pool.

Although the Net N Clean system automates the cleaning of your pool to a large extent, it does not fully eliminate manual operations such as brushing the pool surface or manually vacuuming debris too heavy for the water jets to move (such as sand)

## INSTALLATION INSTRUCTIONS

1. STOP! Ensure system design has been produced by Astral Pool Australia. This will ensure your system operates to maximum potential.
2. It is advisable to have the distributor valve as close to the pool as possible to reduce pipe length. The valve should be positioned at least 300mm above water level. Where the distributor needs to be installed below water level, isolation valves must be connected onto each of the 7 branches plumbed into the bottom plate.
3. Astral Pool Australia recommend the use of a separate (or 2 pump) system for operating your infloor cleaning. Twin suction points should be installed in the swimming pool at least 300mm off the floor and 800mm apart to ensure the Net 'N' Clean system circulates clean water.
4. Nozzles should be placed according to the plan supplied by Astral Pool. This should include nozzles on the floor, steps and benches within the pool.
5. When installing systems into concrete shell pools, Astral Pool reducing conduits (23665) should be used for each nozzle.
6. Once all risers / conduits have been plumbed, blanking caps (supplied with conduits) should be glued into place. The system should then be pressure tested to approx 100kPa and left under pressure to observe any degradation. (This step should be performed before the pour of the concrete)
7. When using reducing conduits, ensure they are only cut within the designated "cutting zone" marked on to the body of the conduit.

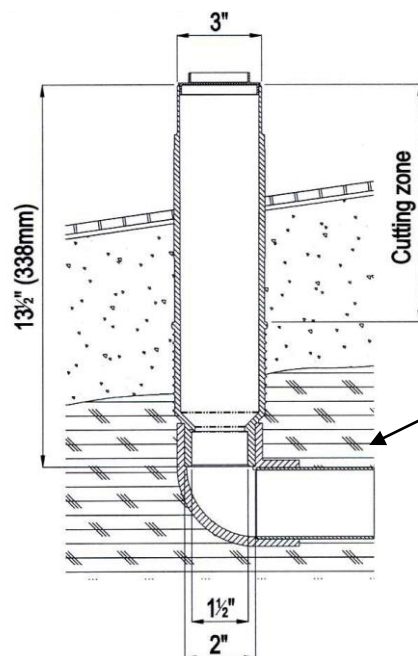

A minimum gravel layer of 50mm should be used around the connection to the riser for each nozzle

8. Once system has been tested, cut conduit (if being used) to the desired length for the pool finish. The nozzle body can now be glued into place. Apply a generous amount of glue to the outside of the nozzle and also to the internal knuckle joint.

Ensure generous amount of glue is applied to this area of the knuckle.



9. Using the spanner supplied, remove all "pop up" sections from the nozzle bodies and fit protection caps to prevent debris entering system while pool is completed.
10. Once pool is ready to fill, remove protective caps and leave nozzle outlets open. Commence filling of the pool water.
11. Once pool level is above the suction points for the cleaning pump, turn system on to purge any dirt and debris situated in the plumbing lines. Once lines are clear, insert nozzle "pop up's" into the nozzle body.

## OPERATION

---

Your Net 'N' Clean infloor cleaning system should be operated in an average pool for 2 – 3 hours per day, usually first up in the morning. This will help to clean any dirt and debris that has settled overnight while the pool system has been shut off.

During this 2 – 3 hour cycle (heavily soiled pools may require longer operating times) the filtration system of the pool must also be operating.

To check for correct operation, the pressure gauge on the distributor valve should indicate between 0.5bar and 1.8bar when a branch is charged and this will reduce during a branch change. As the "pop up's" on each branch rise and fall, they rotate by 30 degrees ready for the next cycle. The operation time will depend on the flow and the number of nozzles per branch. One full cycle could take up to 1.5 to 3 hours.

## MAINTENANCE

---

It is recommended that you check the following at least every 2 weeks

1. Check the pressure gauge on the distributor valve is still operating in the specified range.
2. Open the air purge on the distributor to let air out from inside the valve.

It is recommended that you check the following annually or at the start of each season

1. Check the pressure gauge on the distributor valve is still operating in the specified range.
2. Open the air purge on the distributor to let air out from inside the valve.
3. Clean the inside of the distributor valve, removing any debris which may have settled

## INSTALLATION REQUIREMENTS

### FLOW RATES

The Astral Pool Net 'N' Clean infloor system requires a minimum flow rate of 8 cubic metres per hour (133 lpm) and has a maximum allowable flow rate of 25 cubic metres per hour (417 lpm). The operation of the distributor valve is based on flow through the turbine and is not dependant on pressure. A larger pump will not automatically correct an issue with flow.

The combined flow through the nozzles on any branch must meet the minimum flow rate of 8 cubic metres per hour.

### NOZZLE CONFIGURATIONS

The Net 'N' Clean nozzles have a unique multi configuration system where each one can be set at up to 4 different orifice sizes. As you increase the orifice size, you increase the flow ability of the system.

To alter the configuration of a nozzle,

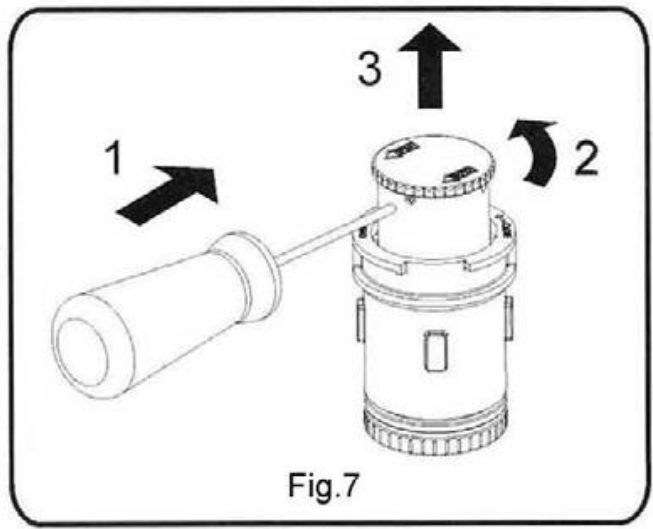
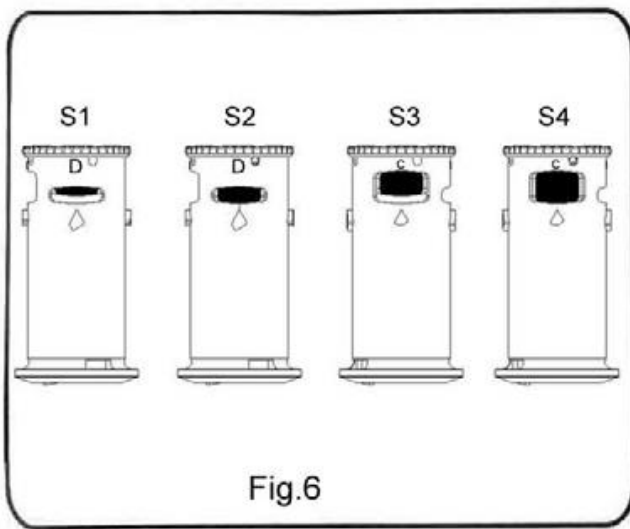

| Nozzle Setting | Combination | Flow Rate         |      | Legth of water jet |
|----------------|-------------|-------------------|------|--------------------|
|                |             | m <sup>3</sup> /h | lpm  |                    |
| S1             | B + D       | 2                 | 33.3 | 0.5 m              |
| S2             | A + D       | 3                 | 50.0 | 1.0 m              |
| S3             | B + C       | 4                 | 66.7 | 1.5 m              |
| S4             | A + C       | 5                 | 83.3 | 1.8 m              |

Reminder: Nozzle combinations per branch must exceed minimum flow rate of 8 cubic metres per hour. No branch can operate with a single nozzle, the minimum combination can be 2 x S<sub>3</sub> or 1 x S<sub>2</sub> and 1 x S<sub>4</sub>.

## NOZZLE REMOVAL / INSERTION

The Net 'N' Clean nozzles have an easy to use spanner for quick removal and insertion of nozzles. This spanner attaches to the end of a standard tele-pole used for manual cleaning system.

To remove or insert a nozzle,

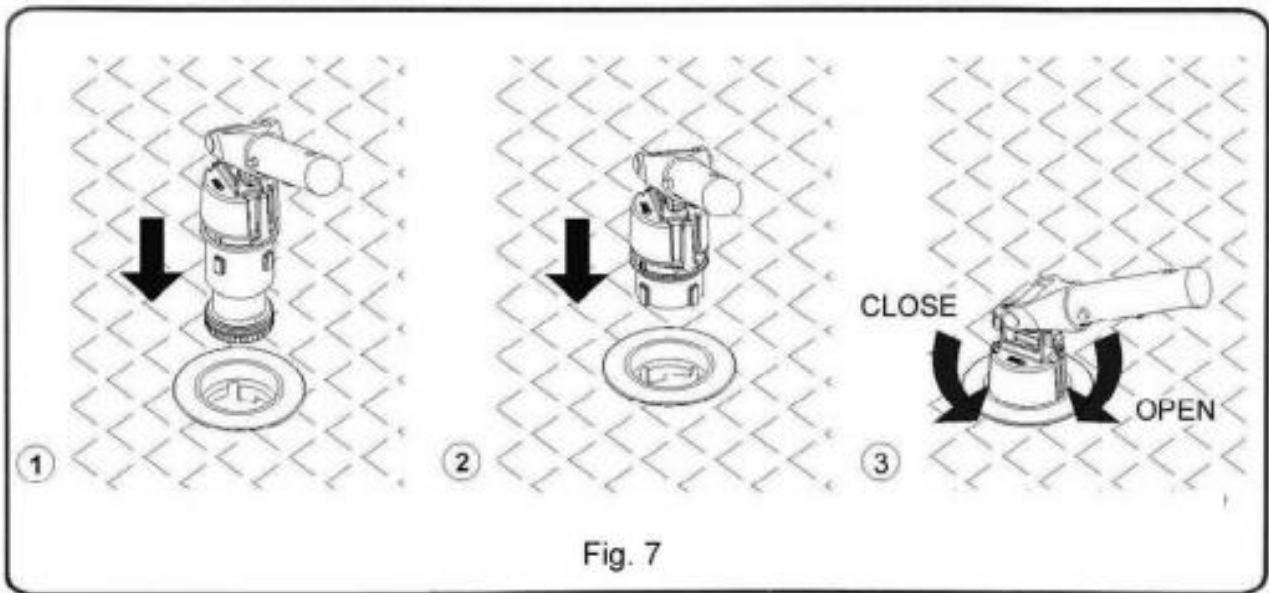

## TROUBLESHOOTING

| PROBLEM   | POSSIBLE CAUSE                                 | SOLUTION   |
|---|--|--|
| The nozzles in more than one circuit are upright. | Worn caps                                      | Replace caps.  |
| The valve does not change circuit                 | Not enough water flow is reaching the impeller | Check that the installation is in accordance with the specifications of this manual.<br>Choose a larger outlet configuration in the nozzles, or change the pump for one with a greater flow. |
|   | The impeller or inside mechanism are blocked   | Dismantle the valve and clean the base plate unit until the gears can be turned by hand.<br>Place the caps in the correct position again.  |
| The joint of the valve is dripping                | The ring is loose                              | Fully tighten the ring.  |
|   | The joint and housing are dirty                | Clean and reassemble.  |
|   | Excess pressure in the valve                   | Choose a larger outlet hole in the nozzles or change the pump for one with less pressure, so that it is in accordance with the specifications of this manual.                                |



Fluidra Group Australia Pty Ltd  
219 Woodpark Road,  
Smithfield. N.S.W 2164  
ABN 87 002 641 965