

K535CBX/18/EU & K535CBX/18/US IM (KOK)(GB)
size: W290 x L420mm

GB POOL VACUUM KIT

- 1. MAIN BODY** (with pre-filter bag inside)
- 2. FLAT NOZZLE & BRUSH**
- 3. CONNECTORS**
- 4. POLES**
- 5. HOSE SECTION**
1 x long hose section (for K636CBX/18/EU)
3 x short hose sections (for K636CBX/18/US)
- 6. HOSE SECTIONS CONNECTORS**
(for K636CBX/18/US only)

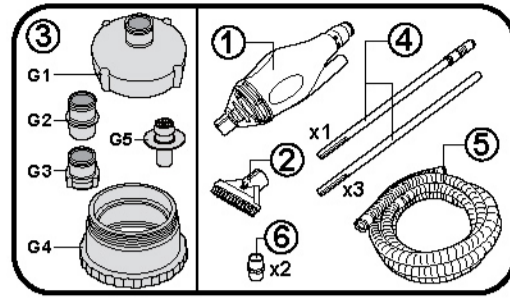

HOW TO ASSEMBLE YOUR SKOOBA™

- Align the rib of the flat nozzle to the notch on the nozzle of cleaner hood and then slide the suction head to the hood until it stops. (Fig.1)
- Select a sufficient number of the pole sections to suit your pool size. Total length should allow both hands to grip during operation. Assemble the pole sections by inserting the grooved end of one section into the round end of the next one, finishing with the last section that has the plastic grip. Slide together until grooved area is fully inserted. (Fig.2)
- Insert the grooved end of assembled poles into the main body securely. (Fig.3)

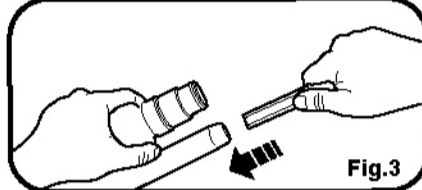
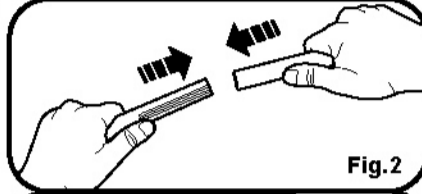
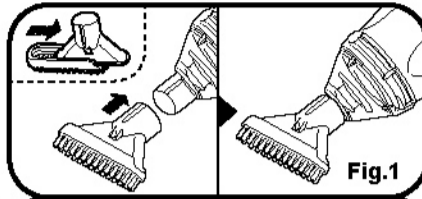

ASSEMBLE THE HOSE TO THE MAIN BODY

NOTE: For 3 short hose sections, connect them with the hose section connectors provided. (Fig.4)

It is recommended to do this underwater to remove all entrapped air.

Tips: To remove entrapped air in the hose, place the hose cuff towards the pool water inlet hole to let water flow in and push out the entrapped air.

After assembling all hose sections, immerse the main body under the water. When bubbles stop coming from the main unit, connect the open end of the hose to the hose cuff of the body and slide on as far as it can go. (Fig.5)

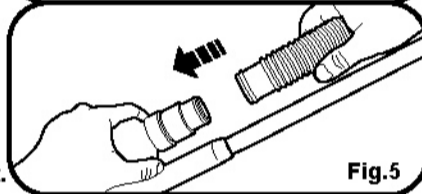
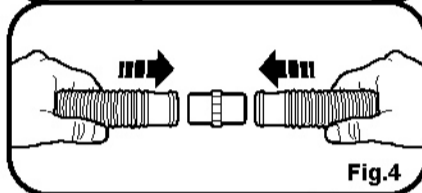

CONNECT SKOOBA™ TO THE POOL OUTLET

WARNING! TURN OFF THE PUMP before connecting SKOOBA™ to the pool outlet.

- If you have a surface wall skimmer: Take the open end of the hose and connect it onto the vacuum plate of your skimmer. Slide the hose as far as it can go and apply clamp (not included) to secure it on the vacuum plate. (Fig.6)
- If you have a wall skimmer, check your pool manual or pool dealer for instructions on how to remove the skimmer weir. Place a skimmer vacuum plate (not included, check with your pool dealer for the correct model with a cuff connection to fit a 1 1/4 in / 32mm soft hose) over the skimmer filter basket. Connect the open end of the hose to the vacuum plate cuff, and slide it on as far as it can go. (Fig.7)

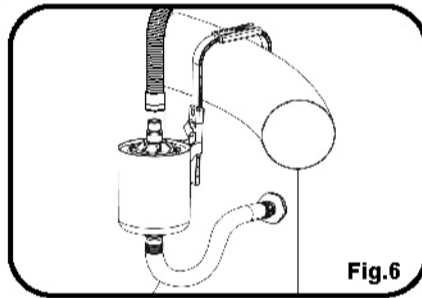

IMPORTANT! Make sure the pool water level is over the vacuum plate, otherwise it will suck-in air during operation.

NOTE: The vacuum plate shown in (Fig.7) diagrams is for demonstration only. Please contact your pool dealer for the correct model. A vacuum plate with a 90 degree elbow is recommended.

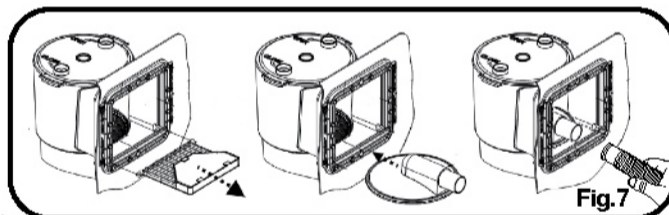

- If you don't have a wall skimmer: 5 connectors (G1/G2/G3/G4/G5) are provided in the kit to fit the 9 most common types of strainer (see below) used in above ground pools. According to the strainer used in your pool, select and attach the correct one to the strainer. Tighten by hand only.

NOTE: For above ground pools with 2 pool water outlets, while connecting the cleaner to one of the water outlets according to the cleaner instruction manual, follow pool instruction manual to block the other water outlet. For example, use pool plug to block the outlet or set the control valve (eg. plunger valve) if available to the closed position. Otherwise, it will weaken the water flow inside the cleaner and then adversely affect the cleaner performance such as capturing less debris.

WARNING! Turn off the pump before closing the water outlet.

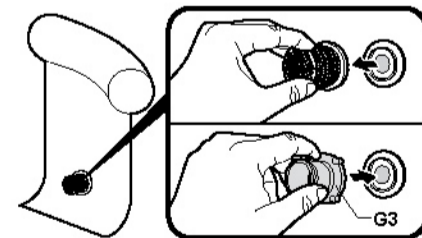

040mm (1 3/8 in) Strainer plug with removable grid cover

Detach the strainer cover and press G3 on it.

040mm (1 3/8 in) Strainer plug with non-removable grid cover
Refer to pool instruction manual for how to remove the strainer plug from the water outlet and then insert G5 connector as shown. **Note:** if your pool strainer plug is secured inside the pool water outlet with pool hose together by hose clamp, you may need to loosen the hose clamp to release the strainer plug. Pay attention not to let the pool hose become detached from the water outlet when loosening the hose clamp. Remove the plug and insert the G5 connector into water outlet as much as possible. Tighten the hose clamp to secure the pool hose and the connector to the water outlet.

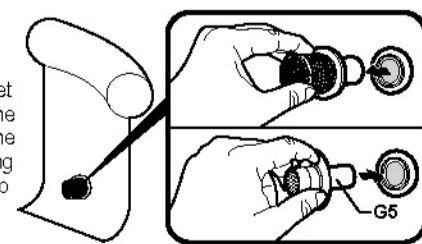

080mm (3 in) Strainer plug with removable grid cover
Unscrew the strainer cover and screw on G1.

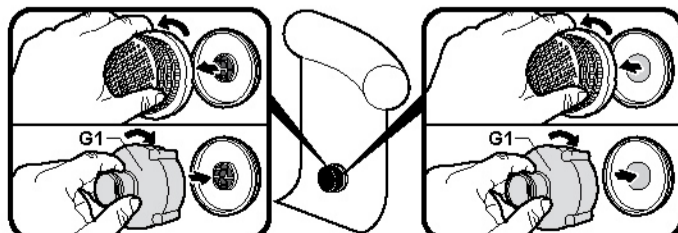

080mm (3 in) Strainer plug with non-removable grid cover
Refer to pool instruction manual for how to remove the strainer plug from the water outlet and then insert G5 connector as shown. **Note:** if your pool strainer plug is secured inside the pool water outlet with pool hose together by hose clamp, you may need to loosen the hose clamp to release the strainer plug. Pay attention not to let the pool hose become detached from the water outlet when loosening the hose clamp. Remove the plug and insert the G5 connector into water outlet as much as possible. Tighten the hose clamp to secure the pool hose and the connector to the water outlet.

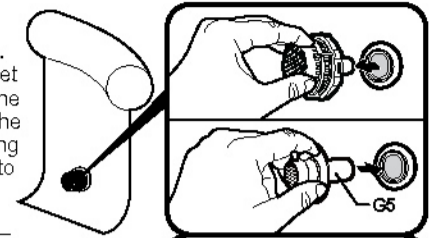

092mm (3 5/8 in) Strainer (with side thread)
Screw G1 onto G4, and then align and screw G4 onto the strainer

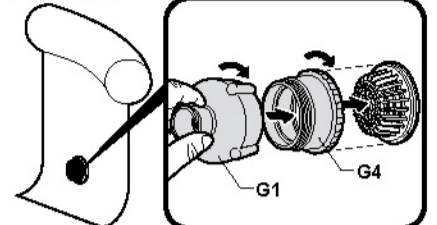

0110mm (4 1/8 in) Strainer
Unscrew the strainer cover and screw G1 onto the middle thread of the strainer.

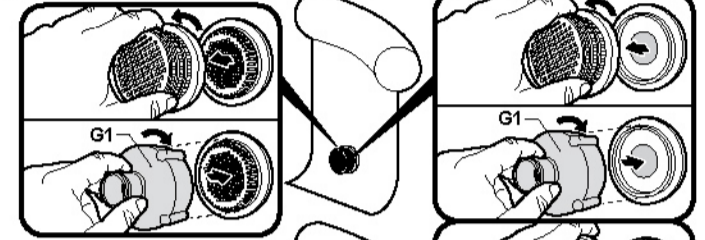

036mm (1 1/8 in) Strainer Hole
Detach the strainer cover and directly insert G2 into the strainer hole.

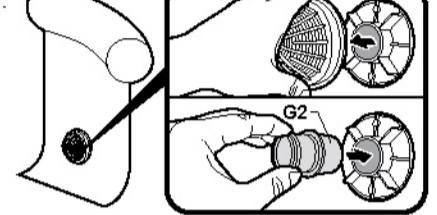

Take the open end of the hose, connect it onto the connector and slide on as far as it can go.

HOW TO OPERATE YOUR SKOOBA™

When your SKOOBA™ is ready, turn your pump ON and start using SKOOBA™ to clean the bottom of your pool. Your SKOOBA™ is made to vacuum debris from the bottom of your pool. The internal pre-filter bag is designed to trap leaves and larger debris, which could otherwise clog the filter of your pool. Make sure to empty this pre-filter bag regularly to ensure the maximum suction power.

NOTE: Never use your SKOOBA™ without the pre-filter bag. Failure to do so may clog the filter of your pool. For vinyl liner and fiberglass pool, it is recommended to keep the brush on the flat nozzle to avoid damaging to the pool.

IMPORTANT: Trapped air in your vacuum system may prevent the pump from operating correctly. In this case, if your pump has a release valve, open it to let air escape until only water comes out from it and then close the valve. Check pump manual how to remove the air.

HOW TO EMPTY THE PRE-FILTER BAG OF SKOOBA™

WARNING! Turn off the pump before emptying the pre-filter bag.

- Remove the hood from the cleaner by turning it anticlockwise until it stops and then take it off from the main body. (Fig.8)
- Pull out the pre-filter bag from the cleaner and remove the leaves and other debris. (Fig.9) Rinse the cover and make sure its suction hole is not clogged.
- Put back the pre-filter bag into the cleaner. Make sure the notch under the top ring covers the edge around the opening of the cleaner. (Fig.10) If pre-filter bag is damaged, replace a new one before next operation.
- Align the rid (on the inside surface of hood bottom) to the slot on the opening of the main body, press down the hood and turn it clockwise until it stops. Make sure the hood is secured on the cleaner before next operation. (Fig.11)

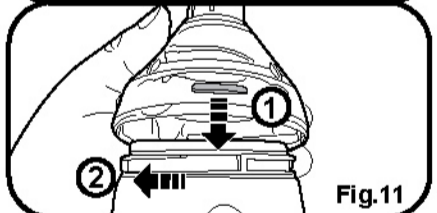
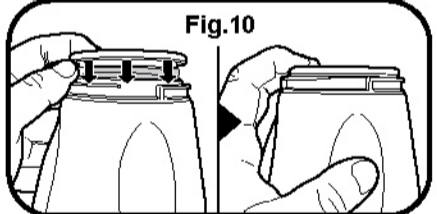
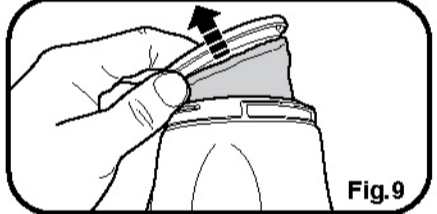
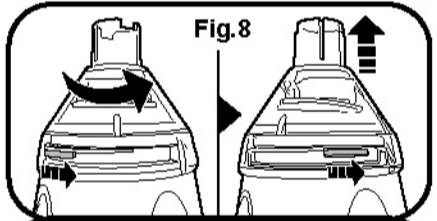

TROUBLE SHOOTING

Problem	Possible Cause	Solution
Poor debris pick-up	Pre-filter bag is full.	Clean the pre-filter bag.
	Not enough suction power.	Make sure that your pool pump power is at least 45W, and minimum system flow rate is 2.0m³/hr (530 gal/hr). Make sure the hose is free of punctures. Check if there are two water outlets on your pool and make sure the water outlet which is connected with cleaner is opened and the other water outlet is closed.
	Obstruction somewhere in the system.	Clean the pump filter. Clean out any debris from the hose. Replace a damaged pre-filter bag that lets debris through.
Hose collapse	Suction nozzle is blocked.	Check and clean out any debris from the nozzle.
	Suction is too strong.	Check if your pump power is over 0.5HP/ 375W and /or filtration system flow is over 1,300gal/5m³.

K535CBX/18/EU & K535CBX/18/US
Made in China
21007029

© 2021 Kokido Development Ltd. All rights reserved. No part of this document may be reproduced or transmitted in any form or by any means, electronic, mechanical, photocopying, recording, or otherwise, without prior written permission of Kokido Development Ltd.

