



## ColorJet LED light

Model No. 60302

DC 4.2V      Max. 0.4W

IP68 1m      Max.ambient: 45°C      Class 2 circuit

### WARNING

READ AND FOLLOW ALL INSTRUCTIONS SAVE THESE INSTRUCTIONS.  
THE LIGHT SOURCE OF THIS LUMINAIRE IS NOT REPLACEABLE; WHEN  
THE LIGHT SOURCE REACHES ITS END OF LIFE THE WHOLE  
LUMINAIRE SHALL BE REPLACED.

### INSTALLATION

Only for HydroJet Spa

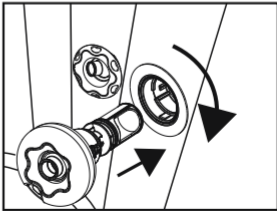
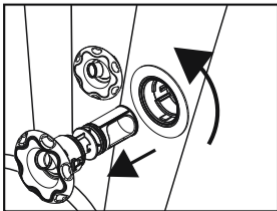

## OPERATION

- Turn on the HydroJet function of your SPA and the light will be on.
- Press the button: Change the light show.
- Press and hold for 3 seconds: Turn off.
- Press again: Turn on.
- Twist the light to adjust the water flow and LED brightness.

**Important:** When the water flow of the HydroJet™ massage system is set to minimum flow, the power of the water will be not enough to activate the light. Use the maximum power of water flow to enjoy the light.

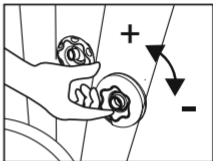

## MAINTENANCE

Store in a dry place when not in use.



# Bestway®

©2020 Bestway Inflatables & Material Corp.

All rights reserved/Tous droits réservés/Todos los derechos reservados/Alle Rechte vorbehalten/Tutti i diritti riservati

®™ Trademarks used in some countries under license to/

Marques ®™ utilisées dans certains pays sous la licence de/

Marcas comerciales ®™ utilizadas en algunos países bajo la licencia de/

®™ Die Warenzeichen werden in einigen Ländern verwendet unter Lizenz der/

®™ Marchi utilizzati in alcuni paesi concessi in licenza a

**Bestway Inflatables & Material Corp., No.3065 Cao An Road, Shanghai, 201812, China.**

Manufactured, distributed and represented in the European Union by/

Fabriqués, distribués et représentés dans l'Union Européenne par/Fabricado, distribuido y representado en la Unión Europea por/

Hergestellt, vertrieben und in der Europäischen Union vertreten von/Prodotto, distribuito e rappresentato nell'Unione Europea da

**Bestway (Europe) S.r.l., Via Resistenza, 5, 20098 San Giuliano Milanese (Milano), Italy**

Distributed in North America by/Distribués en Amérique du Nord par/Distribuido en Norteamérica por

**Bestway (USA) Inc., 3411 E. Harbour Drive, Phoenix, Arizona 85034, United States of America**

Tel: +86 21 69135588 (For U.S. and Canada)

Distributed in Latin America by/Distribués en Amérique latine par/Distribuido en Latinoamérica por/Distribuido na América Latina por

**Bestway Central & South America Ltda, Salar Ascotan 1282, Parque Enea, Pudahuel, Santiago, Chile**

Distributed in Australia & New Zealand by **Bestway Australia Pty Ltd, Unit 2/98-104 Carnarvon St Silverwater, NSW 2128, Australia**

Tel: Australia: (+61) 29 0371 388; New Zealand: 0800 142 101

Exported by/Exporté par/Exportado por/Exportiert von/Esportato da

**Bestway (Hong Kong) International Ltd./Bestway Enterprise Company Limited**

Suite 713, 7/Floor, East Wing, Tsim Sha Tsui Centre, 66 Mody Road, Kowloon, Hong Kong

[www.bestwaycorp.com](http://www.bestwaycorp.com)