



DAVEY

The benefits for you

- Safe for your family
- Therapeutic, soft water for comfort
- Cost effective, low power use, low chemical cost
- User friendly

WHY CHOOSE THE ChloroMatic® Salt Water Chlorinator?

Maximises the value and enjoyment of your pool.

Eziset digital timer for quick and simple set up.

Large, easy to read digital display and LED indicators.

Models available with reverse polarity electrolytic cells for low maintenance.

Large surface area of cell plates for high rate chlorine production.

High flow rate cell design for rapid pool turnover.

Made with corrosion resistant, UV stabilised materials for long service life.

Winter mode setting to reduce sanitiser output during the colder months, saves energy and protects equipment.

'Low salt', 'no flow' indicators and overload protection.

Flow detector stops electrolysis if no flow is present, preventing dangerous gas build-up.

Pump 'cut out' protects the pump when no water detected (on reverse polarity models).

Light transformer available (on some models).

Operating salt level: 4500-6000ppm.



**NOW WITH
50gram/Hour
Output**

DAVEY ChloroMatic® Salt Water Chlorinator

Keep your pool clean and clear with the simple and reliable ChloroMatic®. Australia's favourite chlorinator.



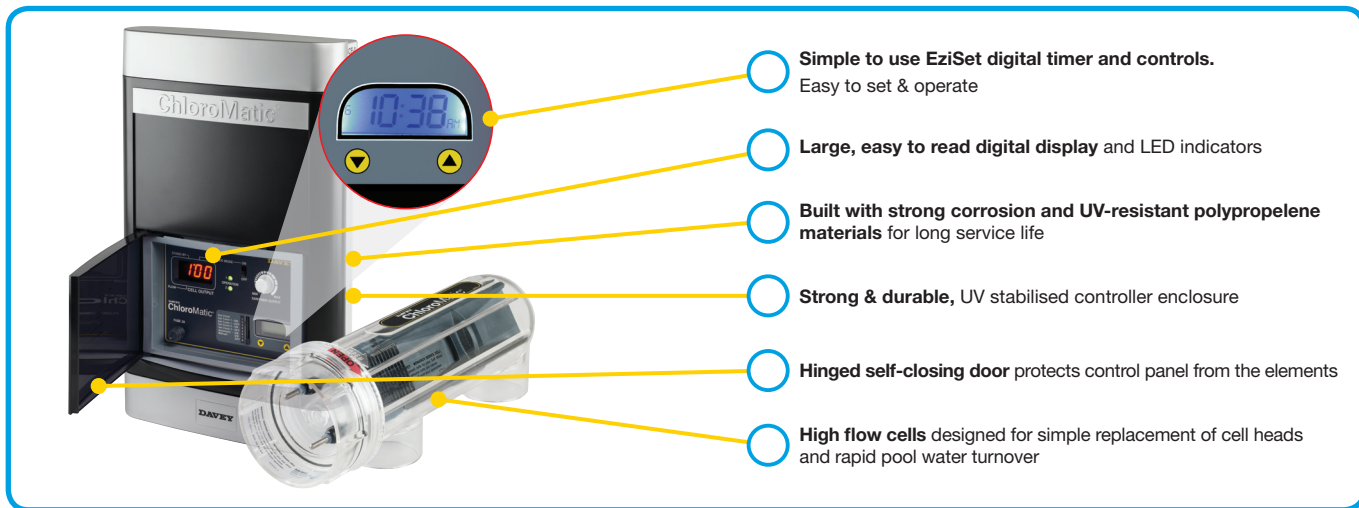

DIMENSIONS (mm)									
	Power Supply Enclosure				Cell Housing				
	Height	Width	Depth	Mounting Holes	Height	Width	Diam	Inlet/Outlet	Plumbing Holes (from centre to centre)
ChloroMatic	390	235	130	66	141	376	123	50	194
50 gm	390	235	130	66	206	415	125	50	214

ELECTRICAL DATA – All models			
Voltage (V)	Supply Freq/Phase	Enclosure Class IP	Approval #
220-240	50Hz / 1	34	W/2333

Model	Chlorine Gas Production g/hr (100%)	Calcium Hypochlorite Equivalent g/hr (65%)	*With optional 12V Pool Light Transformer	Max Pool Size (litres)		
				Cool Climate	Temperate Climate	Hot Climate
Reverse Polarity (Low Maintenance) Systems						
MCS16C	16	25	✓	80,000	50,000	35,000
MCS24C	24	37	✓	120,000	75,000	55,000
MCS36C	36	55	✗	180,000	112,000	80,000
MCS40C	40	62	✗	200,000	125,000	100,000
MCS50C	50	67.5	✗	250,000	200,000	160,000
Non-reversing Systems						
MC16C	16	25	✓	80,000	50,000	35,000
MC20C	20	31	✓	100,000	62,000	44,000
MC30C	30	46	✗	150,000	94,000	66,000

*To order with optional light transformer add 'T' to the end of the model number.

IMPORTANT NOTES:

1. In 'hard water' applications (above 275ppm), reverse polarity systems will require regular (monthly) inspection and manual cleaning.
2. The appropriate chlorinator size for your pool is dependent on the local climate and the bather load of the pool. Please note that chlorinator cell life can be increased with shorter running times during winter and lower output settings. Davey recommends that a chlorinator is run for between 6 - 8 hours a day during summer and between 2 - 4 hours during winter. A 24 hour super chlorination is recommended after heavy pool use.
3. Please read instruction manual for further pool size and running time information.



davey.com.au | daveynz.co.nz

This literature is not a complete guide to product usage. Further information is available from your Davey Dealer, Davey Support Centre and from the relevant product Installation and Operating Instructions. Must be read in conjunction with the relevant product Installation and Operating Instructions and all applicable statutory requirements. Product specifications may change without notice. © Davey is a registered trademark of Davey Water Products Pty Ltd. © Davey Water Products Pty Ltd 2013.